

### TYPE 8RHB

Inductance Range: 1.0-1000 $\mu$ H

Temperature Coefficient: 400ppm/ $^{\circ}$ C, max.

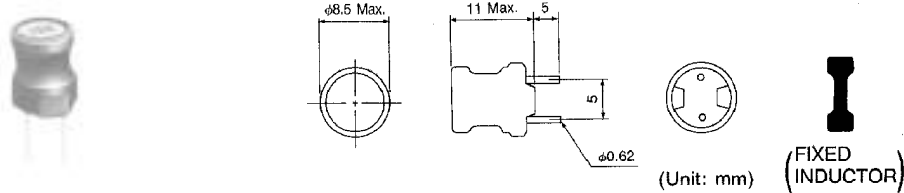

### Features

- Ideal as a choke coil for noise filtering and DC/DC convertor applications.

Note: Taped form is Type 8RHT (see complete specification on page 102).

### STANDARD PARTS SELECTION GUIDE

- (1) Q and Inductance are measured by Q meter YHP-4343B or equivalent.
- (2) The rated DC current is that which the inductance value decreases 10% by the excitation DC current, measured at 1KHz by Precision LCR meter 4284A (hp) or equivalent.
- (3) The rated DC current which the part temperature rises 20 $^{\circ}$ C by the excitation DC current from room temperature (20 $^{\circ}$ ).

- (4) SRF is measured by Network Analyzer 3577A (hp), MS560J (Anritsu) or equivalent.
- (5) DC Resistance is measured by Digital Multimeter TR6871 (Advantest) or equivalent.
- (6) SRF is for reference only.

### TYPE 8RHB

TOKO Part Number	Inductance L ( $\mu$ H)	Q <sup>(1)</sup> (min.)	Test Frequency of L, Qu (MHz)	DC Resistance <sup>(5)</sup> ( ) max.	Rated DC Current <sup>(2)</sup> (A) max.	Rated DC Current <sup>(3)</sup> (A) max.	Self Resonant Frequency <sup>(4), (6)</sup> (MHz) min.
R622LY-1R0M	1.0 $\pm$ 20%	20	7.96	0.013	10	3.71	150
R622LY-1R5M	1.5 $\pm$ 20%	20	7.96	0.016	8.5	3.32	130
R622LY-2R2M	2.2 $\pm$ 20%	20	7.96	0.021	6.5	3.15	100
R622LY-3R3M	3.3 $\pm$ 20%	20	7.96	0.025	5.5	2.66	79
R622LY-4R7M	4.7 $\pm$ 20%	20	7.96	0.030	4.3	2.27	51
R622LY-6R8M	6.8 $\pm$ 20%	20	7.96	0.035	3.7	2.10	29
R622LY-100K	10 $\pm$ 10%	50	2.52	0.045	3.0	1.96	14
R622LY-120K	12 $\pm$ 10%	50	2.52	0.050	2.6	1.82	13
R622LY-150K	15 $\pm$ 10%	50	2.52	0.056	2.3	1.75	12
R622LY-180K	18 $\pm$ 10%	40	2.52	0.061	2.2	1.54	11
R622LY-220K	22 $\pm$ 10%	40	2.52	0.070	2.0	1.29	9.2
R622LY-270K	27 $\pm$ 10%	40	2.52	0.080	1.7	1.22	8.5
R622LY-330K	33 $\pm$ 10%	30	2.52	0.090	1.6	1.17	1.8
R622LY-390K	39 $\pm$ 10%	30	2.52	0.10	1.5	1.14	6.9
R622LY-470K	47 $\pm$ 10%	30	2.52	0.17	1.4	0.79	6.5
R622LY-560K	56 $\pm$ 10%	30	2.52	0.20	1.3	0.76	5.4
R622LY-680K	68 $\pm$ 10%	30	2.52	0.22	1.2	0.70	4.9
R622LY-820K	82 $\pm$ 10%	30	2.52	0.25	1.1	0.67	4.1
R622LY-101K	100 $\pm$ 10%	20	0.796	0.28	0.91	0.58	3.7
R622LY-121K	120 $\pm$ 10%	20	0.796	0.32	0.84	0.56	3.4
R622LY-151K	150 $\pm$ 10%	20	0.796	0.54	0.75	0.42	3.2
R622LY-181K	180 $\pm$ 10%	20	0.796	0.60	0.69	0.40	2.8
R622LY-221K	220 $\pm$ 10%	20	0.796	0.68	0.64	0.38	2.7
R622LY-271K	270 $\pm$ 10%	20	0.796	0.80	0.57	0.35	2.4
R622LY-331K	330 $\pm$ 10%	20	0.796	0.90	0.54	0.33	2.3
R622LY-391K	390 $\pm$ 10%	20	0.796	1.2	0.48	0.28	2.1
R622LY-471K	470 $\pm$ 10%	20	0.796	1.37	0.46	0.25	1.9
R622LY-561K	560 $\pm$ 10%	20	0.796	1.53	0.41	0.23	1.8
R622LY-681K	680 $\pm$ 10%	20	0.796	2.0	0.38	0.21	1.6
R622LY-821K	820 $\pm$ 10%	20	0.796	2.7	0.35	0.18	1.5
R622LY-102K	1,000 $\pm$ 10%	50	0.252	2.96	0.29	0.16	1.3